

BOURG BINDER BB3002 EVA/HOT MELT



BB3002 EVA/Hot melt



Fully automated binder



Fully supports JDF and XML workflows enabling automated job set-ups

**NEW** User-friendly Graphical user Interface (GUI)

Vibration of the jogger plate re-aligns the block of paper to be bound and guarantees high-quality job production



Superior milling and notching ensure deep glue penetration for maximum cover adhesion



Superior EVA / hot melt spine gluing for premier book binding



Adjustable side gluing (accuracy at 0,1 mm/0.004 in)



Highest quality knife creasing function



Extremely precise cover transport and positioning



Automatic barcode scanning for job tracking and to ensure job cover to content integrity (optional)

If you are looking for a perfect binder with excellent return-on-investment, the Bourg Binder BB3002 EVA is an ideal solution. Use it to produce a wide range of book sizes ranging from small square books to large custom sizes.

The BB3002 EVA is the ideal binder for on-demand customized applications and high quality materials such as student handouts and medical prescription books (with innerflaps/winged books and tear-off sheets) from 2 to 600 sheets (with 90 gsm) in record time.

As your needs grow, upgrade your BB3002 with our optional modules, like Bourg Book Loader (BBL) or a Bourg Book Complier (BBC). BB3002 is ready to adapt to your future workflow!

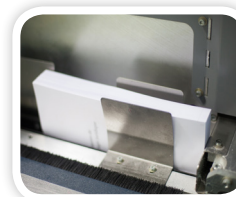
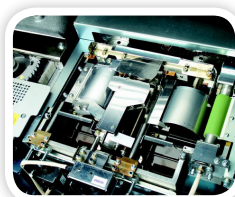

BB3002 EVA measures the book thickness specifications automatically and no manual input is required. All functions including the clamping system, the accuracy adjustment in operation, the barcode scanning, etc. are fully automated.

- Produce up to 350 books/hour (up to 650 cycles/hour) from 100 x 90 mm (3.93 x 3.54 in) to 385 x 380 mm (15.15 x 14.96 in) – the fastest production time for binders on the market.

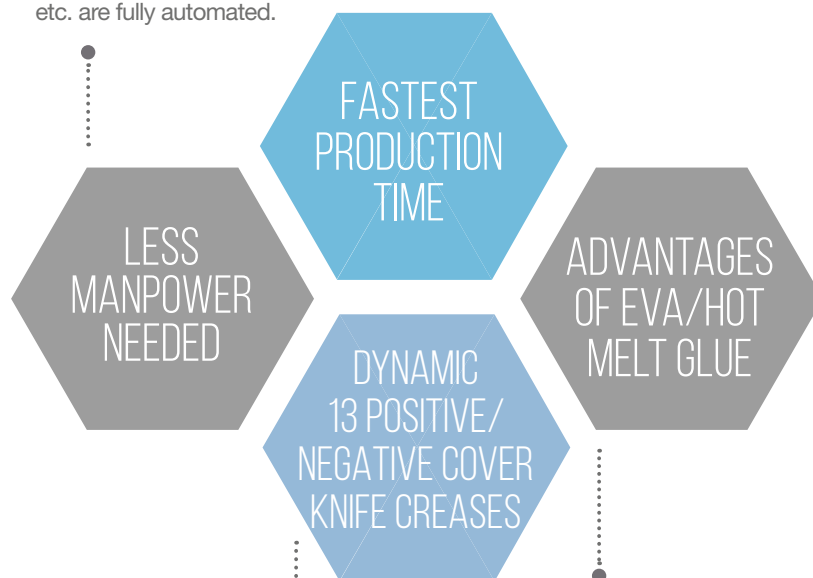

Create a variety of flaps on the cover with our unique high-quality knife creasing function.

Knife creasing offers a superior and cleaner quality result, which avoids damage to the printed surface and cover cracking. Ideal for producing books with inner flaps (winged books).

- 1 Faster production of books.
- 2 Books can be manipulated immediately.
- 3 More economical than PUR; EVA can be remelted; no expiration date on the EVA glue.



c.p. bourg
Your Partner in Print Finishing

OFF-LINE

IN-LINE
WITH BBCDUAL-MODE
WITH BSF

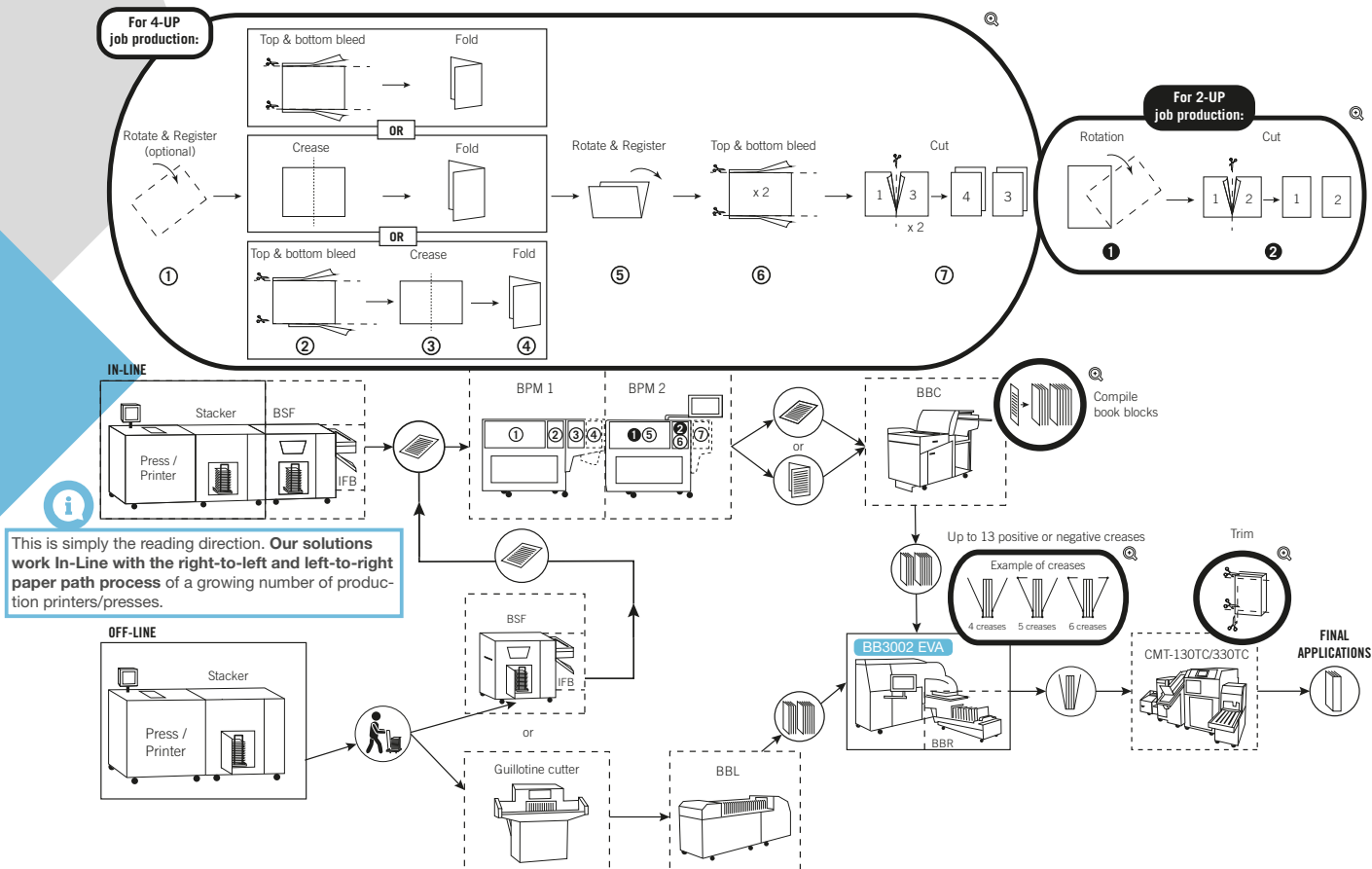

It has only been in a few a weeks but the binder BB3002 EVA is already making a significant difference thanks to an improved bind, plus an expansion to the services we can offer cost-effectively in-house. We wanted to add value to what we doing and so looked into offering wings on the covers of our perfect bound books and magazines. It is another string to our bow.

Mike Coates, Managing Director,
The Russel Press, UK



Contact our local distributor to get
your personalised solution
www.cpbourg.com/distributors

TECHNICAL SPECIFICATIONS

Media

Maximum speed	650 cycles/hour 350 books/hour (operator dependent)
---------------	---

COVER

Cover weight	80 to 300 gsm
--------------	---------------

CONTENT

Milling depth	0 to 3 mm (0 to 0.11 in)
Paper weight	60 to 160 gsm

Physical

Dimensions (L x W x H)	202 x 240 x 150 cm (79.52 x 94.48 x 59.05 in)
Weight	650 kg (1,430 lbs)
Glue temperature	130 to 180 °C (266°F to 356 °F)
Cover station capacity / cover pile height	80 mm (3.15 in)
BBR capacity	700 mm (27.55 in)

Electrical

Power supply	208/220V ±10%, 60Hz, 3 phase delta, 12A 220/230 or 240V ±10%, 50Hz, 3 phase delta, 12A 380/400 or 415V ±10%, 50Hz, 3 phase star, no neutral needed, 12A
--------------	---

Options / Accessories

1D barcode systems & imposition solutions
Bourg Book Reception Module (BBR)
First aid kit
Upgrade kit to use BBL or BBC
Double cover detection (included)
6 meters long vacuum tube
Paper dust extraction kit (230V only)
Enhanced paper dust extraction kit

Connectability

Bourg Book Compiler (BBC)
Bourg Sheet Feeder (BSF) with BBC
Bourg Book Loader (BBL)
Book Trimmer CMT-130TC (CMT-130TC)
Three-Knife Trimmer CMT-330TC (CMT-330TC)

MEDIA SIZES

Perfect binding mode

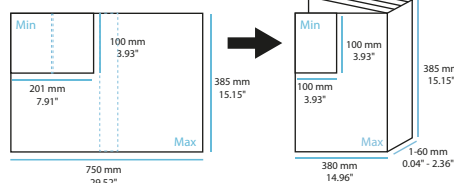

Padding mode

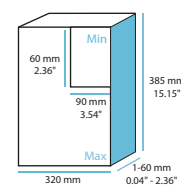

BOURG BINDER BB3002 PUR-COMPACT



BB3002 PUR-C



Fully automated binder



Fully supports JDF and XML workflows enabling automated job set-ups

**NEW** User-friendly Graphical user Interface (GUI)

Vibration of the jogger plate re-aligns the block of paper to be bound and guarantees high-quality job production



Superior milling and defibering ensure deep glue penetration for maximum cover adhesion



Quality PUR bound books



Glue capacity of 2 or 4 kg



Adjustable side gluing (accuracy at 0,1 mm/0.004 in)



Highest quality knife creasing function



Automatic barcode scanning for job tracking and to ensure job cover to content integrity (optional)

Choose the Bourg Binder BB3002 PUR-C to produce soft cover books and on-demand full-color printed books such as perfect bound photo books in a cost-effective way.

The combination of C.P. Bourg and Nordson technologies offers a consistent and reliable performance with precise dispensing of PUR adhesive glue, clean cut-off and the highest quality creasing, with increased productivity by reducing clean-up and shortening start-up/shutdown time.

For additional flexibility, you can use the BB3002 PUR-C also with EVA / hot melt glue.



The BB3002 PUR-C measures the book thickness specifications automatically and no manual input is required. Produce up to 285 books/hour (up to 650 cycles/hour) – the fastest production time for one clamp PUR binders on the market. For achieving maximum efficiency, add a Bourg Book Loader (BBL), a Bourg Book Compiler (BBC) and/or a trimmer CMT-130TC or a CMT-330TC.

- 1 Better finishing: lay flat book production.
- 2 Durable: more resistant to wear & tear.
- 3 Better application: for digitally printed silicone coated sheets.
- 4 Sustainable: lower consumption of glue and energy trimmer.

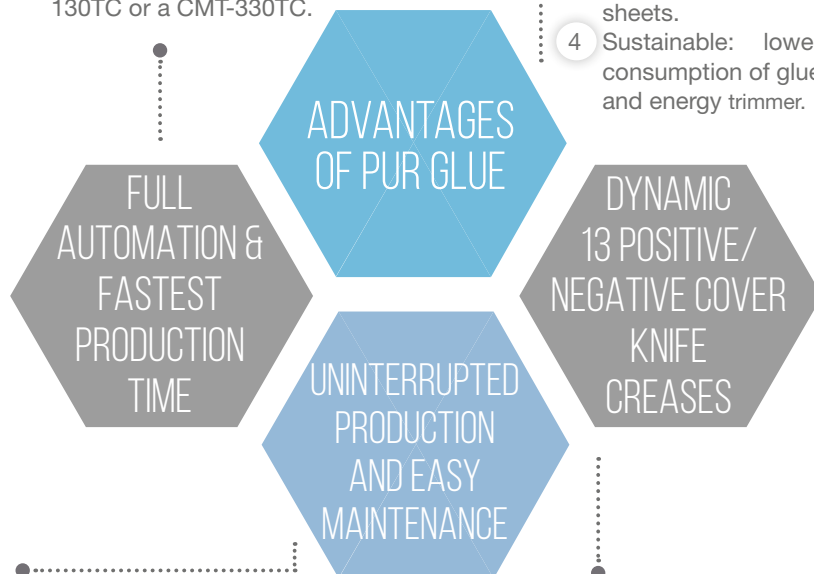

With the Nordson applicator the BB3002 PUR-C does not need to be stopped for refilling or constant cleaning. Just empty the purge cup when you start the machine.

Create a variety of flaps on the cover with our unique high-quality knife creasing function.

The system is fully closed, so there is no health hazard for the operator and no need to use lower-quality PUR glue.

OFF-LINE

IN-LINE
WITH BBCDUAL-MODE
WITH BSF

c.p. bourg
Your Partner in Print Finishing

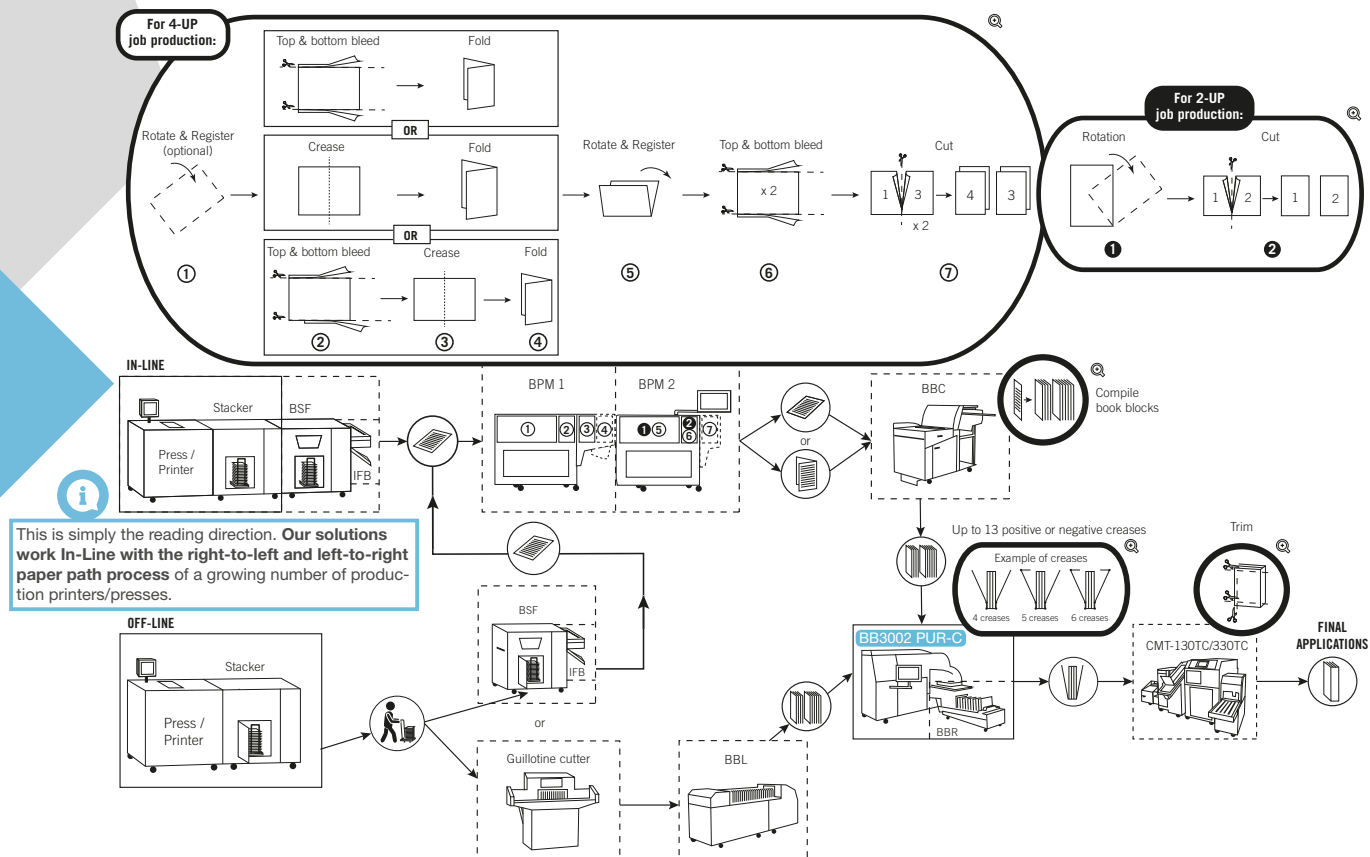

“ The BB3002 has a simple touchscreen interface and doesn't need any tools for job changeovers, so the operator doesn't need to be an expert. We can create professional-looking books fast, at a reasonable cost and completely on-demand. ”



Raj Nadrajan, Director of the In-plant print & finishing department, Simon Fraser University, Canada

Contact our local distributor to get your personalised solution
www.cpbourg.com/distributors

TECHNICAL SPECIFICATIONS

Media

Maximum speed	650 cycles/hour 250-285 books/hour (operator dependent)
---------------	---

COVER

Cover weight	80 to 300 gsm
--------------	---------------

CONTENT (Padding mode is not available with PUR version due to cure time)

Milling depth	0 to 3 mm (0 to 0.11 in)
Paper weight	60 to 160 gsm

Physical

Dimensions of BB3002 (L x W x H)	202 x 135 x 150 cm (79.52 x 53.15 x 59.05 in)
Dimensions of PUR-C (L x W x H)	30 x 55 x 110 cm (11.81 x 21.65 x 43.30 in)
Weight of BB3002	650 kg (1,430 lbs)
Weight of PUR-C	42 kg (92 lbs)
Glue capacity	2 or 4 kg
Cover Station Capacity / cover pile height	80 mm (3.14 in)
BBR Capacity	700 mm (27.56 in)

Electrical

Power supply	208/220V $\pm 10\%$, 60Hz, 3 phase delta, 12A 220/230V or 240V $\pm 10\%$, 50Hz, 3 phase delta, 12A 380/400 or 415V $\pm 10\%$, 50Hz, 3 phase star, no neutral needed, 12A
--------------	---

Options / Accessories

1D barcode systems & imposition solutions
 Bourg Book Reception Module (BBR)
 First aid kit
 Upgrade kit to use BBL or BBC
 Double cover detection (included)
 6 meters long vacuum tube
 Paper dust extraction kit (230V only)
 Enhanced paper dust extraction kit

Connectability

Bourg Book Compiler (BBC)
 Bourg Sheet Feeder (BSF) with BBC
 Bourg Book Loader (BBL)
 Book Trimmer CMT-130TC (CMT-130TC)
 Three-Knife Trimmer CMT-330TC (CMT-330TC)

Air supply for PUR-C system

Requires compressed air (compressor not included) & constant air quality: see the website for more information

MEDIA SIZES

Perfect binding mode

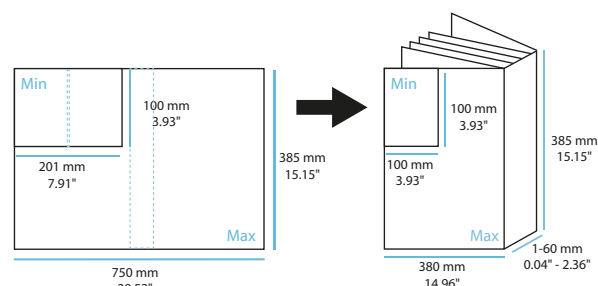



Use the Bourg Book Compiler (BBC) to connect the BB3002 perfect binder In-Line behind a printer; or Off-Line/Dual-Mode behind a Bourg Sheet Feeder (BSF) to process jobs from other printers.

The BBC compiles sheets or single fold signatures, coming from the previous devices, and immediately transfers the compiled stack into the book binder. This automated procedure increases your productivity as it eliminates the need for an operator intervention and waiting time.



Fully autonomous In-Line binder, no human intervention



Binder works at constant maximum speed of up to 650 cycles/hour



Advantages of In-Line use



Flexibility to use one print finishing solution for several printers thanks to the BSF (Dual-mode)



Automatic barcode scanning for job tracking and to ensure job cover to content integrity (optional)



Upgrade your BB3002 to a BB3202 with the BBC

Each job is checked in order to avoid reprints; each job is recorded for job tracking; no manual job set-up.

Print to finish on-the-fly for increased productivity without losing book integrity.

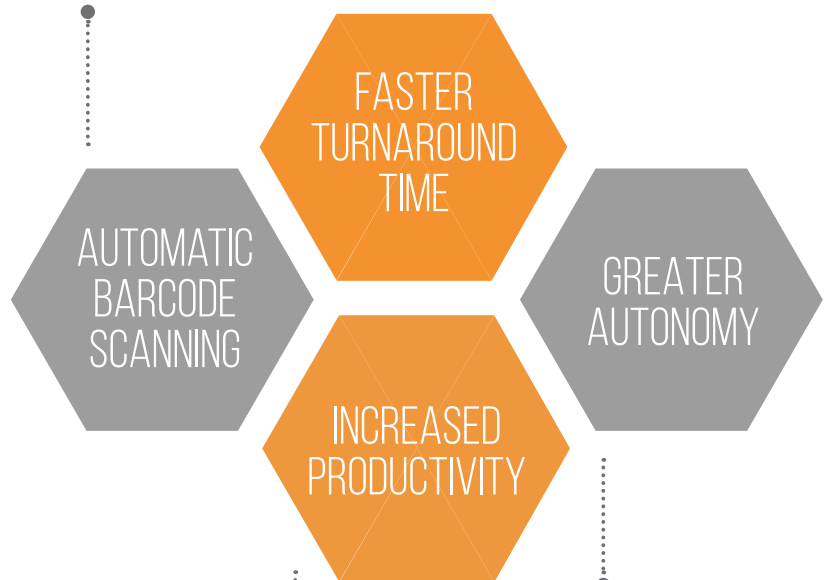

Fast compiling book blocks with thickness from 1 to 60 mm (0.04-2.36 in).

Reduce risk of errors and limit human intervention. The operator may work on several production lines while this solution works autonomously.





Media

Physical

Electrical

Options / Accessories

Barcode systems

Connectability

Bourg Sheet Feeder (BSF)
Bourg Binder 3002 EVA / Hot melt
(BB3002 EVA)
Bourg Binder 3002 PUR-Compact
(BB3002 PUR-C)

MEDIA SIZES

In-Line mode

Perfect binding mode

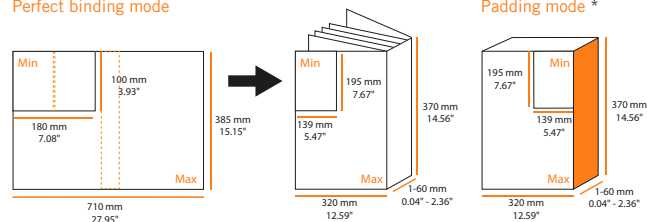

* Padding mode is not available with PUR version due to cure time

Legal notice: All technical information are subject to change without prior notice. As C.P. Bourg's products are always evolving to meet your needs, please visit our website www.cpbourg.com for the most updated information. **More technical details and videos:** www.cpbourg.com/bbc



2

Dual feeding station: flexibility add covers and inserts in the top feeding station



Lower feeding station: compatible with over 30 carts/trolleys



Compressed airflow positioning



Suction belt & air sheet separation technology



Optical Mark Recognition sensors (OMR)



Accuracy adjustments up to 1 mm in increments of 0,02 mm



Jam detection



Ultrasonic Double and Miss Control (DMC)



Automatic purge feature for faulted jobs



Fully supports JDF and XML workflows enabling automated job set-ups



User-friendly Graphical User Interface (GUI) (optional)



Barcode reader capabilities 1D and 2D (optional)



Manual feeding possible and ejection of double feeds (IFB) (optional)

With the Dual-Mode Bourg Sheet Feeder (BSF) you have the advantage of using both Off-Line and In-Line finishing: simply share one finishing device between multiple printers/presses. Switch between the two modes to increase productivity without loss of integrity. This results in increased productivity and reduces the risk of damaged sheets, stacking errors and personal injuries.



The BSF is the only one in its category that is able to feed up to 18,000 sheets/hour and accepts wide range of papers. Combine 3 different modes, depending on your needs (In-Line/Off-Line/Dual-Mode).

By connecting two BSFs together, your production line is now able to work continuously without interruptions due to paper shortage. Output is uninterrupted and productivity is maintained at 100%.

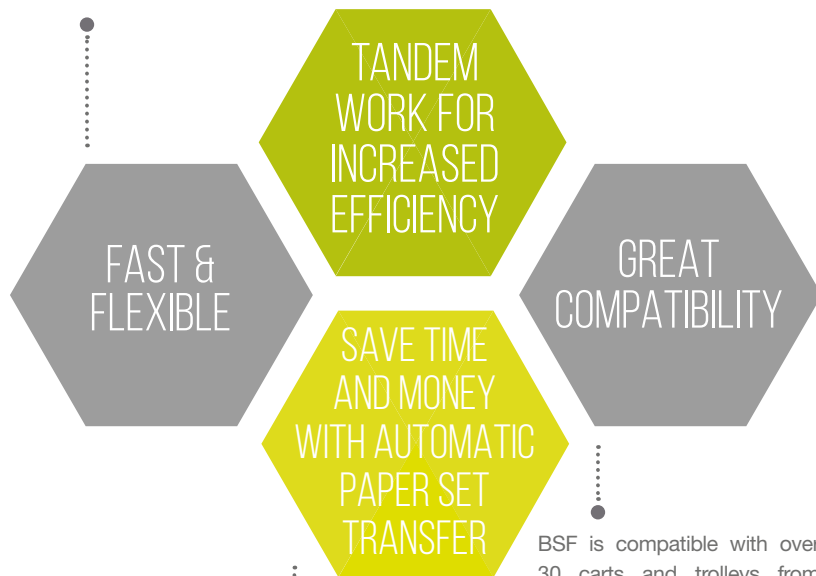

By automatically transferring print output from different manufacturers' stacker carts into the sheet feeder and centering the stack, the BSF makes it easy for users in on-demand print environments to reap the productivity benefits offered by Off-Line volume finishing. Additionally, the manual top feeding station loads capacity up to 140 mm (5.51 in) of printed, coated or laminated materials.

BSF is compatible with over 30 carts and trolleys from the majority of production printer/presses. BSF is also fully compatible with other C.P. Bourg products, like booklet makers and book binders. Find the full list of compatible C.P. Bourg products in the technical specifications on the back of this sheet and on our website: <https://www.cpbourg.com/bsf>

This is simply the reading direction. **Our solutions are bi-directional.** They work In-Line with the right-to-left and left-to-right paper path process of a growing number of production printers/presses.

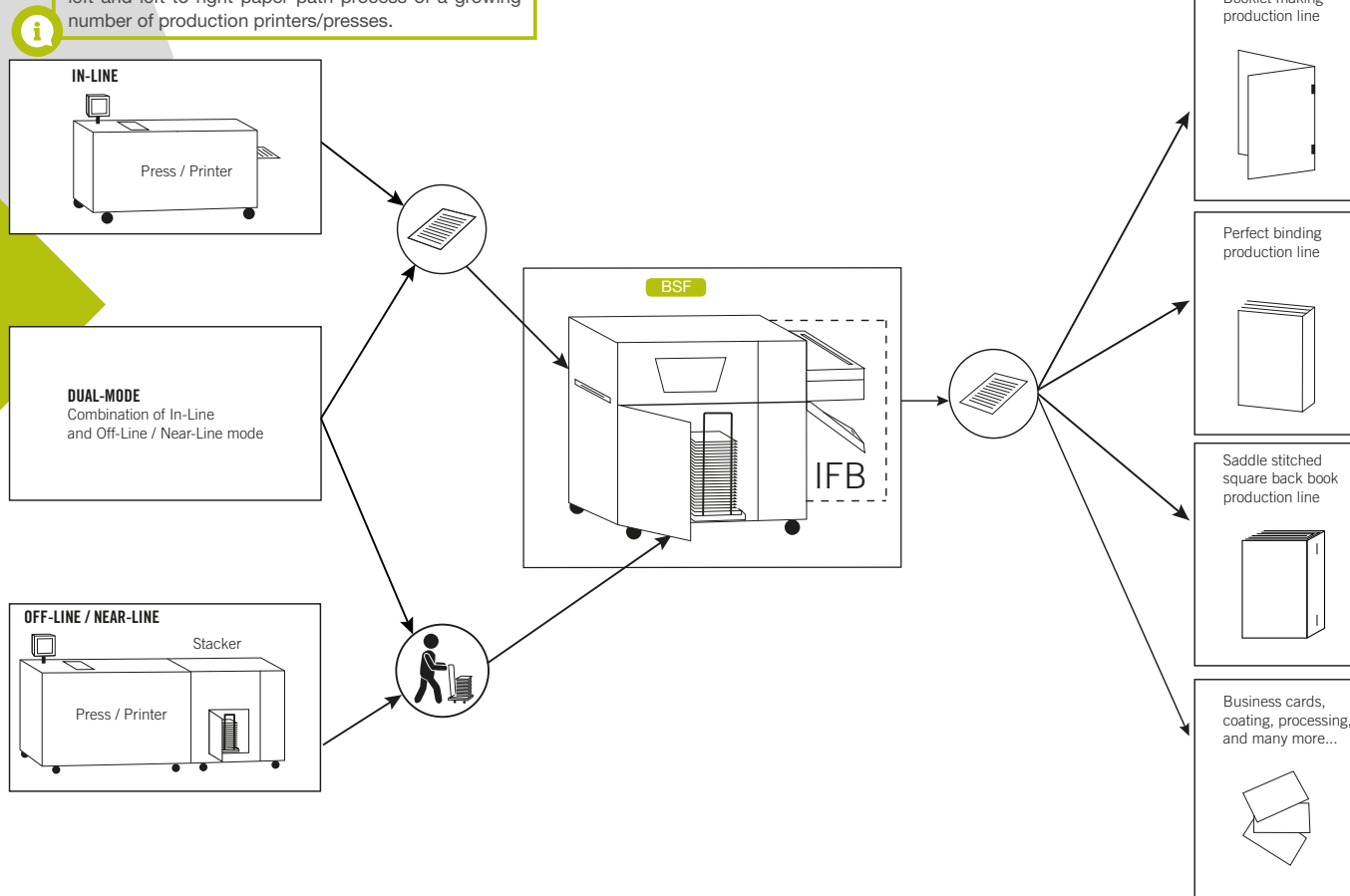

BSF

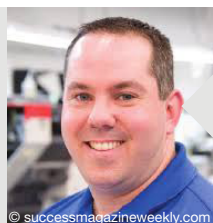

© successmagazineweekly.com

“ This In-Line Bourg booklet making solution (BSF + BCM-e + BM-e + SQE) with our In-Line digital press pays for itself within 2.5 years. Everything is more efficient. It takes us less time to get work out of the door and the end results look great. ”

John DerBoghossian, CEO, Camelot, USA



Contact our local distributor to get your personalised solution

www.cpbourg.com/distributors

TECHNICAL SPECIFICATIONS

Media

Maximum speed	18,000 sheets/hour (A4 sheets, 90 gsm)
Paper weight	60 to 350 gsm

Physical

Dimensions (L x W x H)	133 x 91,3 x 131,6 cm (52.36 x 35.94 x 51.81 in)
Weight	470 kg (1036.17 lbs)
Number of stations	2 stations (drawer, high pile)
Drawer capacity (pile height)	140 mm (5.51 in)
High pile capacity (pile height)	500 mm (19.68 in)

Electrical

Power supply	120V +/-10%, 60Hz, 10,5A 230V +/- 10%, 50Hz, 6,5A
--------------	--

Options / Accessories

Carts / trolleys / pallets & related compatibility kits
IFB reject tray
GUI (touch screen interface)
Barcode reader kits 1D/2D or 1D only
BSF handheld barcode reader
Imposition solutions
Bourg Box Communication Interface (BB)

Connectability

A second Bourg Sheet Feeder (BSF)
Bourg Document Finisher (BDF-e) - Bourg Booklet Maker (BM-e)
Bourg Preparation Module (BPM)
Bourg Binder 3202 EVA / Hot melt / PUR-Compact (BB3202)
Bourg Bleed Crease Module (BCM-e)
+ Various printers/presses and partner products (for more information, visit the website)

MEDIA SIZES

Using the drawer or the bypass mode

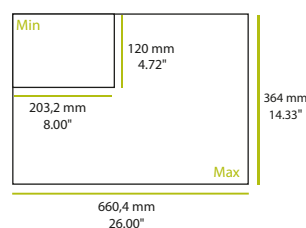

Using the high pile

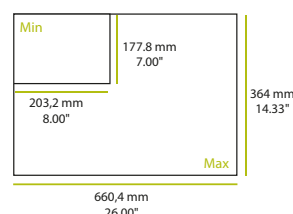

Legal notice: All technical information are subject to change without prior notice. As C.P. Bourg's products are always evolving to meet your needs, please visit our website www.cpbourg.com for the most updated information. More technical details and videos: www.cpbourg.com/bsf

CARTS/TROLLEYS FOR THE BSF



CARTS



C.P. BOURG GENERIC CART



Easy manoeuvrable cart : 360°



Sturdy steel long lasting design

We offer over 30 carts and trolleys compatible with various printers/presses and stackers that can easily feed stacks of pre-collated documents (digital color, digital monochrome or from off set presses) in the Bourg Sheet Feeder (BSF).

One C.P. Bourg generic cart is included in our package when investing in a BSF.

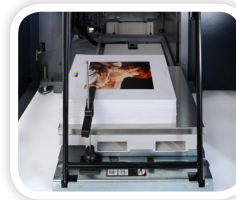

Just unload the cart/trolley from your stacker without lifting the paper stack and transfer it into the Bourg Sheet Feeder (BSF) directly. As a result : you save time and there is no risk for your operators health and safety.

- Find the full list of compatible carts/trolleys of the major production printers/presses on the back of this sheet and on our website:

www.cpbourg.com/carts



As the operator does not need to manipulate the stack of paper, it remains perfectly aligned and there is no risk to loose the set integrity.

By connecting two BSFs together, you can load and unload one BSF while the other one is running. Your production line is therefore working continuously without interruptions due to paper shortage. Output is uninterrupted and productivity is maintained at 100%.



c.p. bourg°
Your Partner in Print Finishing

OFF-LINE

CARTS / PALLETS / TROLLEYS

CARTS



Universal 26" Cart for BSF.
One universal cart is supplied with every BSF.
(Air table included).



Cart for Canon/Océ VP6000, imagePRESS C800, C10000VP/C8000VP and i200/300.
(Air table not included).



Air table cart for HP Indigo 3500, 5000 and 7000 series stackers.

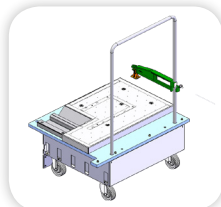

Air table cart kit for Xerox DocuColor DC 5000-8000 Series.
(It includes: 1 kit to enable DC8000 compatible carts in BSF + 1 alternate DC8000 cart compatible with BSF).

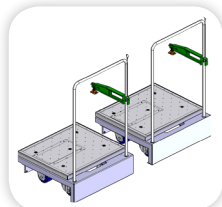

Double air table cart kit for Kodak Digimaster High Capacity Stackers.
(It includes: 2 alternate carts for Digimaster compatible with BSF).



Air table cart for Kodak NEXFINITY and NexPress Digital Presses 20.5" stacker.
(Cart kit for Kodak NEXFINITY and NexPress SX2100+, 2700, 3300, 3900 20.5" stacker).



Air table cart for Kodak NEXFINITY and NexPress Digital Presses 26" stacker.
(Cart kit for Kodak NEXFINITY and NexPress SX2100+, 2700, 3300, 3900 26" stacker).

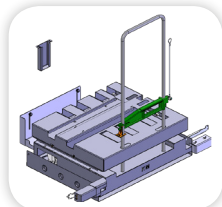

Cart kit for Konica Minolta BizhubPress stacker.



Pallet air table (without wheels) for HP Indigo 3500, 5000 and 7000 series stackers.



Air table cart kit for Xerox iGen 3&4 (20.5").

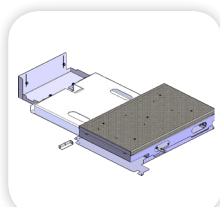

Air table cart compatibility kit for Xerox iGen 150 (26").

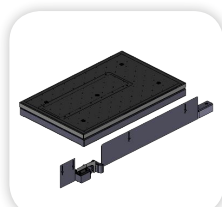

BSF kit for Xerox mediaCart device
(It includes: 1 kit to enable MediaCart usage on BSF with BSF air table).

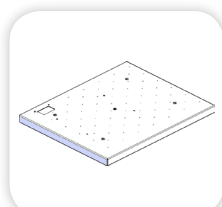

Air table cart kit for Xerox DocuTech & upgrade kit for Nuvera DS5000 stacker.

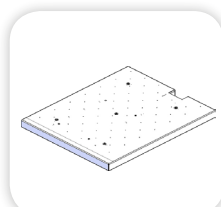

Air table cart upgrade kit for Xerox Nuvera DS3500 stacker.

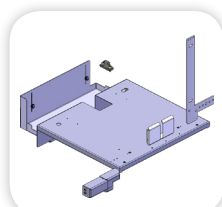

Cart kit for Xerox stacker compatible with Xerox ColorPress 800/1000, D136, Versant 180/2100/3100 and Iridesse.
(It includes: 1 kit to upgrade ColorPress/Versant cart to BSF).

CARTS / PALLETS / TROLLEYS COMPATIBILITY KITS

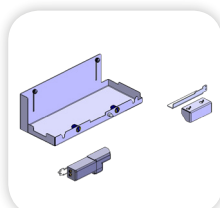

BSF Option - Konica Minolta BizhubPress Compatibility.
Option for BSF purchased before 01/2015 - Standard feature for BSF purchased after 01/2015 (with TAG 039).

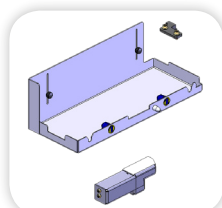

BSF Option - Xerox ColorPress Compatibility.
Option for BSF purchased before 01/2015 - Standard feature for BSF purchased after 01/2015 (with TAG 039).

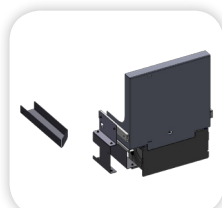

BSF Option - Xerox DocuColor Compatibility.
Option for BSF - Xerox DocuColor Compatibility.

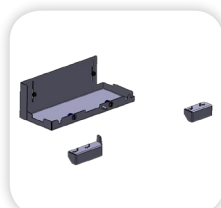

BSF Option - Xerox iGen 3&4 (20.5") Compatibility.
Option for BSF purchased before 01/2015 - Standard feature for BSF purchased after 01/2015 (with TAG 039).

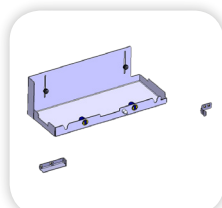

BSF Option - Xerox iGen 150 (26") Compatibility.
Option for BSF purchased before 01/2015 - Standard feature for BSF purchased after 01/2015 (with TAG 039).



Contact our local distributor to get
your personalised solution
www.cpbourg.com/distributors

BOURG SHEET PREPARATION MODULE



BPM



Automatically transforms SRA3 input to A5/A4 books and booklets



Economies of scale through single-pass production of creative book formats



Increased reliability and full integrity check with optional barcode system in the BSF



Fully supports JDF and XML workflows enabling automated job set-ups



Dynamic cut, fold, bleed and crease of each sheet with very high quality and precision



Eliminates the use of post-processing guillotine trim



On-the-fly waste removal for continuous production



Increase the output speed of your current/future C.P. Bourg print finishing solution



Compatible with all C.P. Bourg booklet making and BB3x02 perfect binding products



Multiple media types for covers, book/booklet content and inserts, can be processed together

The Bourg Sheet Preparation Module (BPM) is a fully automated, modular and scalable sheet preparation unit that vastly simplifies the creation of perfect bound and stitched books and booklets. Connect a BPM to selected digital printers/presses and to a Bourg binder or booklet maker and produce finished products of many different sizes with no operator intervention.

Use a single paper size for any book format: BPM converts sheets from large to small formats in one pass, enabling multiple book or booklet formats from media of a single size. This single-pass conversion process also makes multi-up imposition possible and reducing click charges. Ultimately you deliver higher-quality, more cost-effective books and booklets in shorter turnaround times.

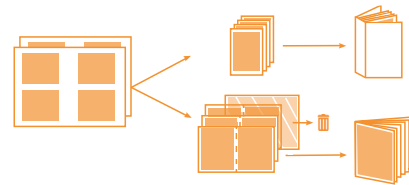

Use a single BPM for 1-up and 2-up jobs, or scale up to 4-up jobs with a second BPM.

The BPM is designed to operate seamlessly with the right-to-left or left-to-right paper path and Duplex 4-up formats of digital printers/presses.

The BPM eliminates or reduces many time consuming, manual processes. The fully automated process maximizes productivity, frees operators for other tasks, and minimizes the risk of human error.

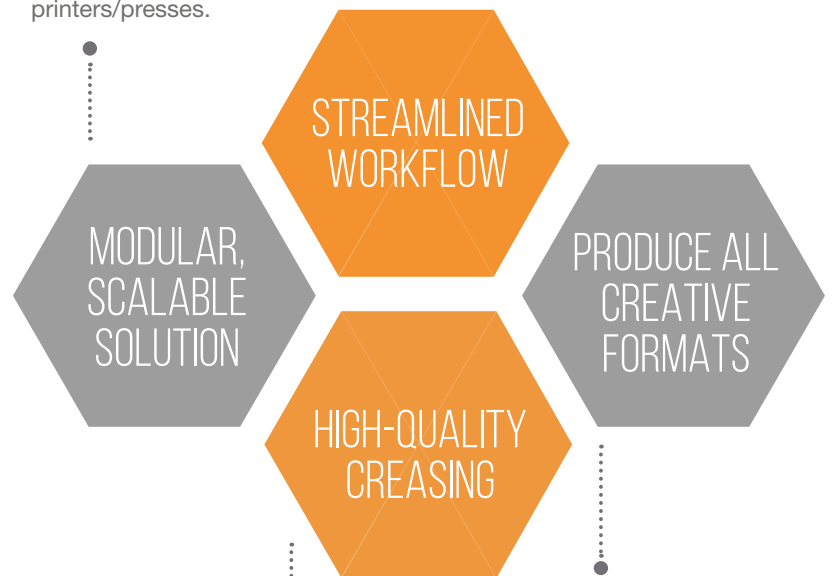

Advanced technology creases sheets on the fly with very high position precision, while the highest quality knife creasing gives the best results without damaging the printed surface.

Innovative bleed trimming system cuts paper on all four edges, trimming symmetrically or asymmetrically from 4 to 100 mm (from 0.16 to 3.94 in) of coated or uncoated sheets.



c.p. bourg®

Your Partner in Print Finishing

OFF-LINE

IN-LINE

DUAL-MODE
WITH BSF

This is simply the reading direction. Our solutions are **bi-directional**. They work In-Line with the right-to-left and left-to-right paper path process of a growing number of production printers/presses.

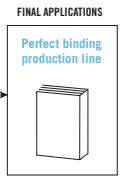
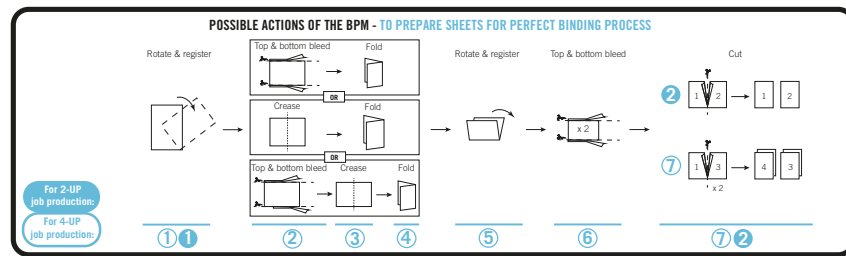
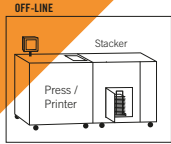
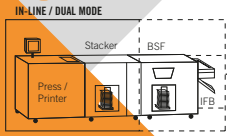

OR

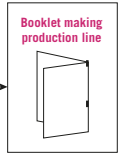
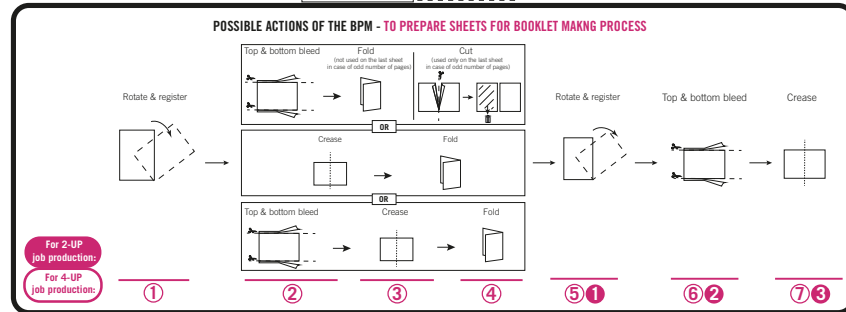

BPM



Thanks to the BPM, the quality of the booklets produced increased, we save a lot of production time and use of operator time thanks to the full automation of the manufacturing process. The market is changing, there is a growing need for automation, it is key for our business. The BPM is the right answer to this need.



Joris Bosch, Technical Director, Wihabo, The Netherlands

Contact our local distributor to get your personalised solution

www.cpbourg.com/distributors

TECHNICAL SPECIFICATIONS

Media

Productivity	A4 LEF : 300 spm - A3 LEF: 200 spm
Incoming velocity	Adjustable 0,8 to 2 m/s (2.6 to 6.5 ft/s)

TOP & BOTTOM TRIM

Trim size tolerance	0,4 mm (0.01 in)
---------------------	------------------

CREASE

Crease position tolerance	0,4 mm (0.01 in)
---------------------------	------------------

CUT

Cut position tolerance	0,4 mm (0.01 in)
------------------------	------------------

Options / Accessories

Barcode system in the BSF & imposition solutions

Connectability

Bourg Sheet Feeder (BSF) - Bourg Document Finisher (BDF-e)
Bourg Booklet Maker (BM-e) - Bourg Binder 3202 EVA/PUR-C (BB3202 EVA/PUR-C)
+ Various partner products (for more information, visit the website)

Physical

Dimensions of BPM with 1 slot/unit (L x W x H)	108 x 88 x 104,5-112 cm (42.51 x 34.64 x 41.14-44.09 in)
Dimensions of BPM with 2 slot/unit (L x W x H)	133 x 88 x 104,5-112 cm (52.36 x 34.64 x 41.14-44.09 in)
Dimensions of BPM with 3 slot/unit (L x W x H)	158 x 88 x 104,5-112 cm (62.20 x 34.64 x 41.14-44.09 in)
Weight of the BPM without any slot/unit	241,5 kg (532.41 lbs)
Weight of the bleeder unit	33 kg (72.75 lbs)
Weight of the cutter unit	33,5 kg (73.85 lbs)
Weight of the creaser unit	41 kg (90.38 lbs)
Weight of the folder unit	38 kg (83.77 lbs)
Weight of the Graphical User Interface (GUI)	3,5 kg (7.71 lbs)

MEDIA SIZES

Bypass mode

In all cases

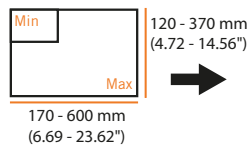

Rotation & registration

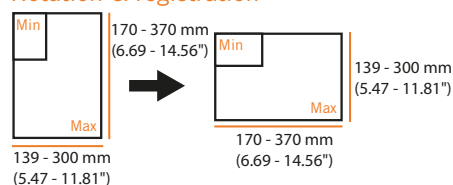

Top & bottom bleed

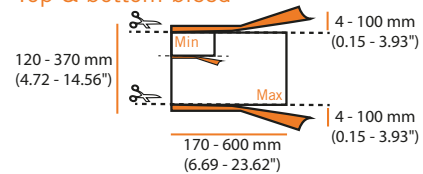

Crease

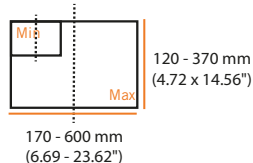

Fold

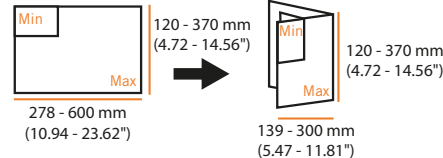

Cut

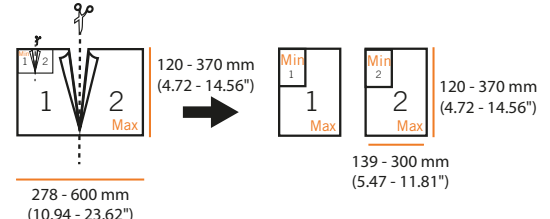

Legal notice: All technical information are subject to change without prior notice. As C.P. Bourg's products are always evolving to meet your needs, please visit our website www.cpbourg.com for the most updated information. More technical details and videos: www.cpbourg.com/bpm

BOURG WALKOVER BRIDGE



BWO

The Bourg WalkOver bridge (BWO) is a conveyor that connects the Bourg BB3202 binder or the Bourg BM-e booklet maker to production printers/presses.

It is a shortcut for the operator: a quick access from the User Interface of the binder/booklet maker to the one of the printer/press.

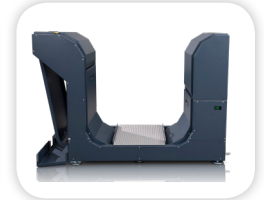

Let the Bourg Box included in the BWO do the work for you: instructions for incoming jobs are converted in the pre-press software into an electronic JDF/JMF job ticket. When Print Manager submits the job to the printer, it sends the corresponding JDF/JMF job ticket to the Bourg Box. The Bourg Box then translates those instructions for the connected Bourg finishing modules.

The BWO is compatible with a wide range of Right-to-Left and Left-to-Right paper workflow printers/presses & all Bourg finishing modules. The height of the input module of the BWO adapts to the height of your press/printer.

Find the full list of compatible printers/presses & products on our website:

<https://www.cpbourg.com/bwo>



Increased efficiency: time-saving shortcut for the operator



Maximize throughput and time between the jobs



Minimize potential for errors and waste



Optimize turnaround time



Compatible with all Bourg finishing modules via the Bourg Sheet Feeder (BSF)



Two-way communication between your printer and Bourg finishing modules with DFA/DFD compliant devices

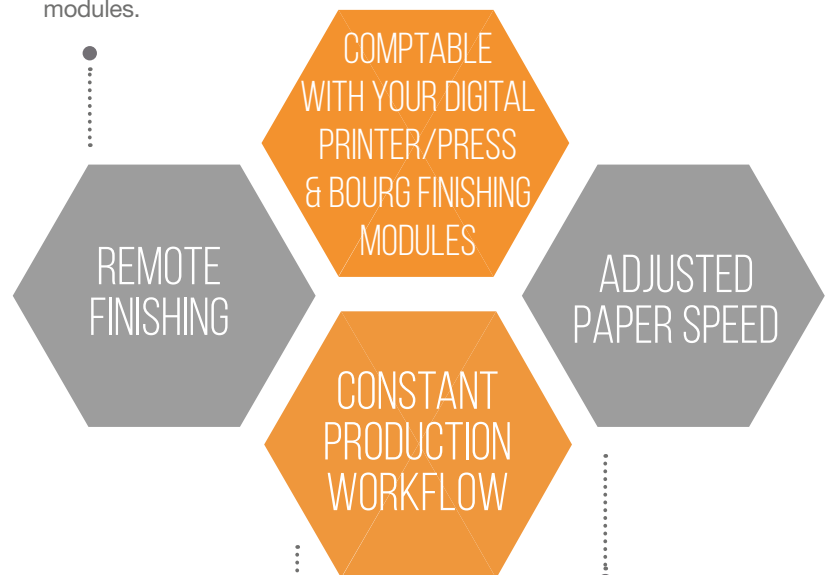

The integrated reject tray automatically ejected jammed paper to maintain your productivity to 100%.

The BWO matches the paper speed between your printer and C.P. Bourg finishing modules without slowing down the printing speed & performances.



c.p. bourg
Your Partner in Print Finishing

IN-LINE

DUAL-MODE
WITH BSF

OPERATOR'S CURRENT WORKFLOW

Example with a perfect binding solution:

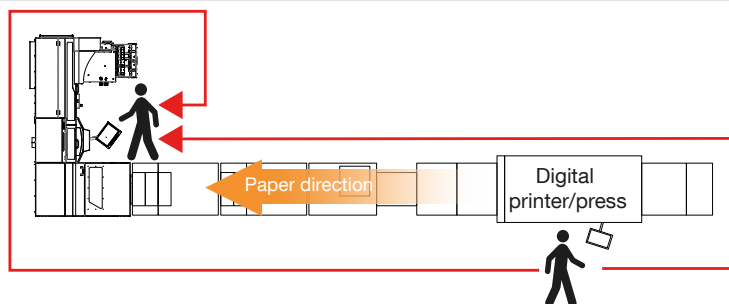

BWO

OPERATOR'S NEW WORKFLOW WITH BWO

Example with a perfect binding solution:

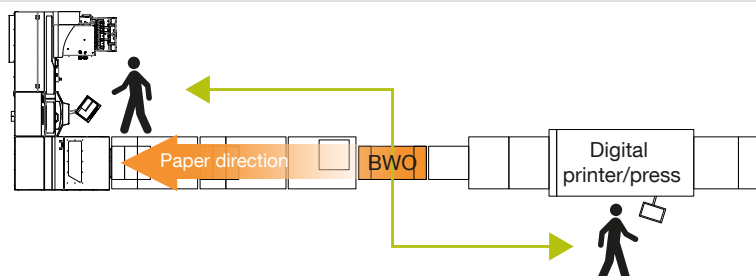

Example with a booklet making solution:

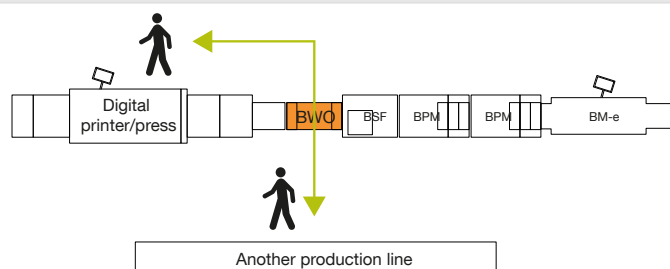

Contact our local distributor to get
your personalised solution
www.cpbourg.com/distributors

TECHNICAL SPECIFICATIONS

Media

PAPER WEIGHT

Coated	60 to 350 gsm
Uncoated	50 to 350 gsm

PAPER VELOCITY

Speed	600 to 2 000 mm/s
-------	-------------------

Physical

Dimensions (L x W x H)	130,5 x 56,8 x min. 75,2 to max. 106,2 cm (51.37 x 22.36 x min. 29.60 to max. 41.81 in)
Weight	132 kg (291.01 lbs)

Electrical

Power supply	120V ±10%, 50/60Hz, 2A 230V ±10%, 50+60Hz, 1A
--------------	--

Connectability

Bourg Sheet Feeder (BSF) to connect to all Bourg booklet-making & perfect-binding finishing modules
+ Various printers/presses (for more information, visit the website)

MEDIA SIZES

140 - 660 mm
(5.51 x 25.98")

178 - 370 mm
(7.00 x 14.56")

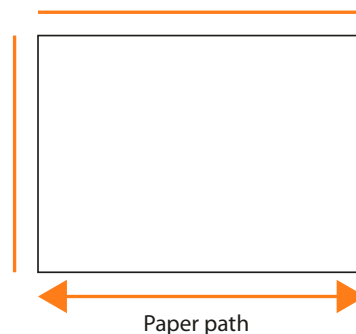



BARCODE UPGRADE FOR THE BSF



Automatic job integrity check



Automatic job set-up on finishing device through JDF or pre-saved jobs (on selected finishers only)



Real-time statistics



Hand-held external barcode reader or integrated barcode reader in BSF

BARCODE UPGRADE FOR THE BB3X02 & THE CMT PRODUCT FAMILIES



Automatic job integrity check on BB3x02



CMT knife trimming family job selection/set-up from barcode on cover (no manual job set-up required)



Real-time statistics

C.P. Bourg's products can be equipped with two types of barcodes allowing you to achieve record breaking efficiency:

1. The latest 1D and 2D barcode reader technology. It can be equipped on the BSF and includes a hand-held external or integrated system.
2. The latest integrated barcode reading technology. It can be equipped on the BB3002 perfect binding family and the CMT knife trimming family.

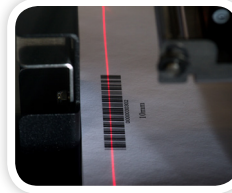
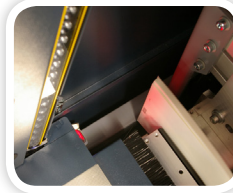

The incorporated 1D and 2D barcode reader technology in your BSF provides automatic job set-up on finishing device through JDF or pre-saved jobs (on selected finishers only, visit our website for more information). Each page is scanned guaranteeing a complete job and a systematic traceability. You save time configuring/processing variable data jobs. In case of a faulted job, the job can be easily reprinted.

- The barcode upgrade for the BB3x02 perfect binding family and the CMT knife trimming family offers cover to content matching to ensure your production's job integrity. No manual job set-up is required since the system is integrated in the machine.



The barcode upgrade system for the BSF offers you the possibility to either let the system scanning each page to check for set integrity and/or automate the job set-up through a barcode identifying job ID. This can be performed with the hand-held external barcode reader or internal reader.

Follow your production with real-time statistics with both type of barcode upgrade systems.



Automatic or manual scanning



Scan each page
1D and 2D barcode
+ automatic job set-up capabilities

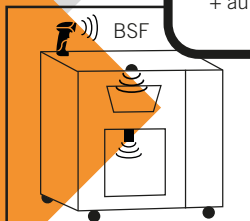

Automatic scanning



Scan the cover
1D barcode
+ automatic job set-up capabilities

CMT-130TC/330TC

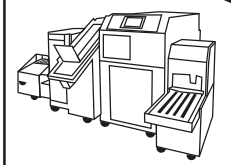

Automatic scanning



Scan the content: last sheet
1D barcode

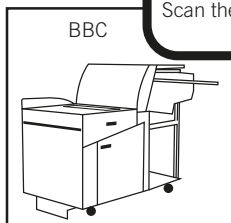

Automatic scanning



Scan the content: last sheet
1D barcode

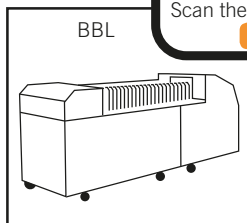

Automatic scanning



Scan the content: first sheet
+ scan the cover
1D barcode

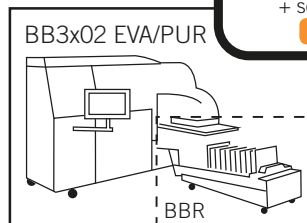

Contact our local distributor to get
your personalised solution
www.cpbourg.com/distributors

TECHNICAL SPECIFICATIONS

Connectability for the barcode upgrade for the BSF

Bourg Sheet Feeder (BSF)

Connectability for the barcode upgrade for the BB3x02 & CMT product families

Bourg Binder BB3x02 EVA / Hot melt / PUR-C family
CMT knife trimmer family

Connectability for the barcode imposition software

Compatible with any finishing equipment and can be integrated with any PDF workflow



Legal notice: All technical information are subject to change without prior notice. As C.P. Bourg's products are always evolving to meet your needs, please visit our website www.cpbourg.com for the most updated information. More technical details and videos: www.cpbourg.com/barcode-systems

ULTIMATE TECHNOGRAPHICS IMPOSITION & FINISHING AUTOMATION



SOFTWARE



AUTOMATE IMPOSITION SOFTWARE: ULTIMATE IMPOSTRIP® AUTOMATION



Generate job ticket sheets and dynamic barcodes for advanced job tracking and job integrity



Connect & integrate any upstream system using JDF/XML to automate printing and finishing processes



Save your template information and preference to your hot folder. It then creates as many plates or sheets needed to complete the job

ADVANCED IMPOSITION SOFTWARE: ULTIMATE IMPOSTRIP® SCALABLE



Reach high speed imposition process and group jobs of different quantities and sizes

FULL AUTOMATION SOFTWARE: ULTIMATE BINDERY®



Validate jobs for C.P. Bourg finishing devices to avoid the creation of impossible jobs and waste



Reduce repetitive manual set-ups, reduce errors, and increase the number of jobs you get done in a day.

Enhance C.P. Bourg's print finishing solutions with Ultimate TechnoGraphics finishing workflow solutions to increase the productivity on each job.

By combining Ultimate Impostrip® Automation or Scalable and Ultimate Bindery®, the C.P. Bourg device will read the job barcode, adjust job set-up automatically, check the job integrity and produce all jobs within the full stack of variable short run jobs without manual intervention.

This is the best way to create a fully automated pre-press to finishing workflow to dynamically drive on demand book or booklet of one.

Combine Ultimate Bindery® with Ultimate Impostrip® Automation or Scalable for a full JDF/JMF imposition and finishing automation workflow solution.

It operates as a central location to validate that each job is built respecting the capabilities and constraints of the selected finishing equipment. These validations prevent errors and reduce waste since an alert is sent to the user for them to rectify the situation.

● In a very little time, set up a link to your management system (MIS), your online photo editing system workflow or web ordering system. Perfect for very short turnaround delivery on marketing campaigns, transactional and short run of books and booklets.

Use this software to create dynamic barcodes to automate press imposition and finishing processes and eliminate manual make-ready.

With the AUTOMATIC LAYOUT SELECTOR, Ultimate Impostrip® provides an Agent choosing the best set up for your job, managing many impositions with a single point of entry.

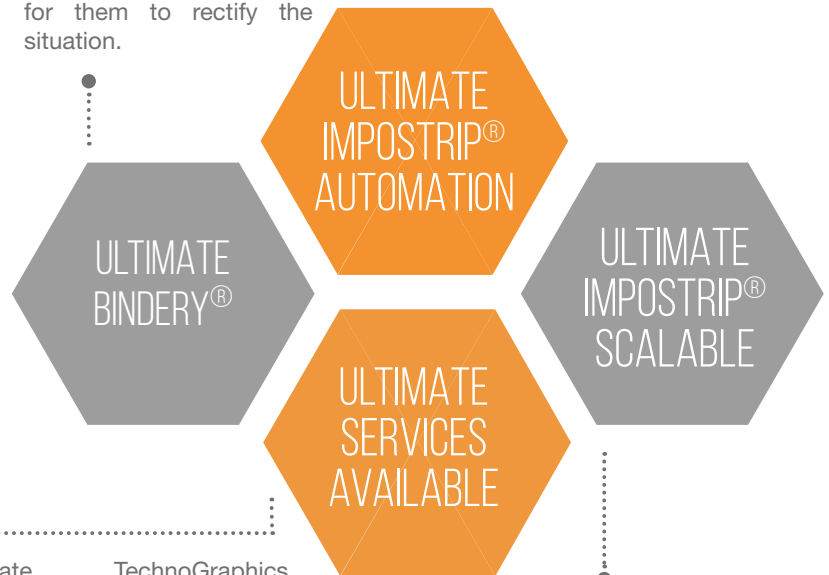

● Ultimate TechnoGraphics solutions are designed to maximize C.P. Bourg devices flexibility and feature set. You may also get custom functionalities for your specific needs, technical services and personalized training.

● Ultimate Impostrip® Scalable is designed to resolve the growing bottleneck in imposition due to increasing job sizes and number of short runs that must be printed in a very quick turnaround time. It provides the prepress processing speed and scalability needed to print high volume of books and booklets.



c.p. bourg®

Your Partner in Print Finishing

OFF-LINE

IN-LINE

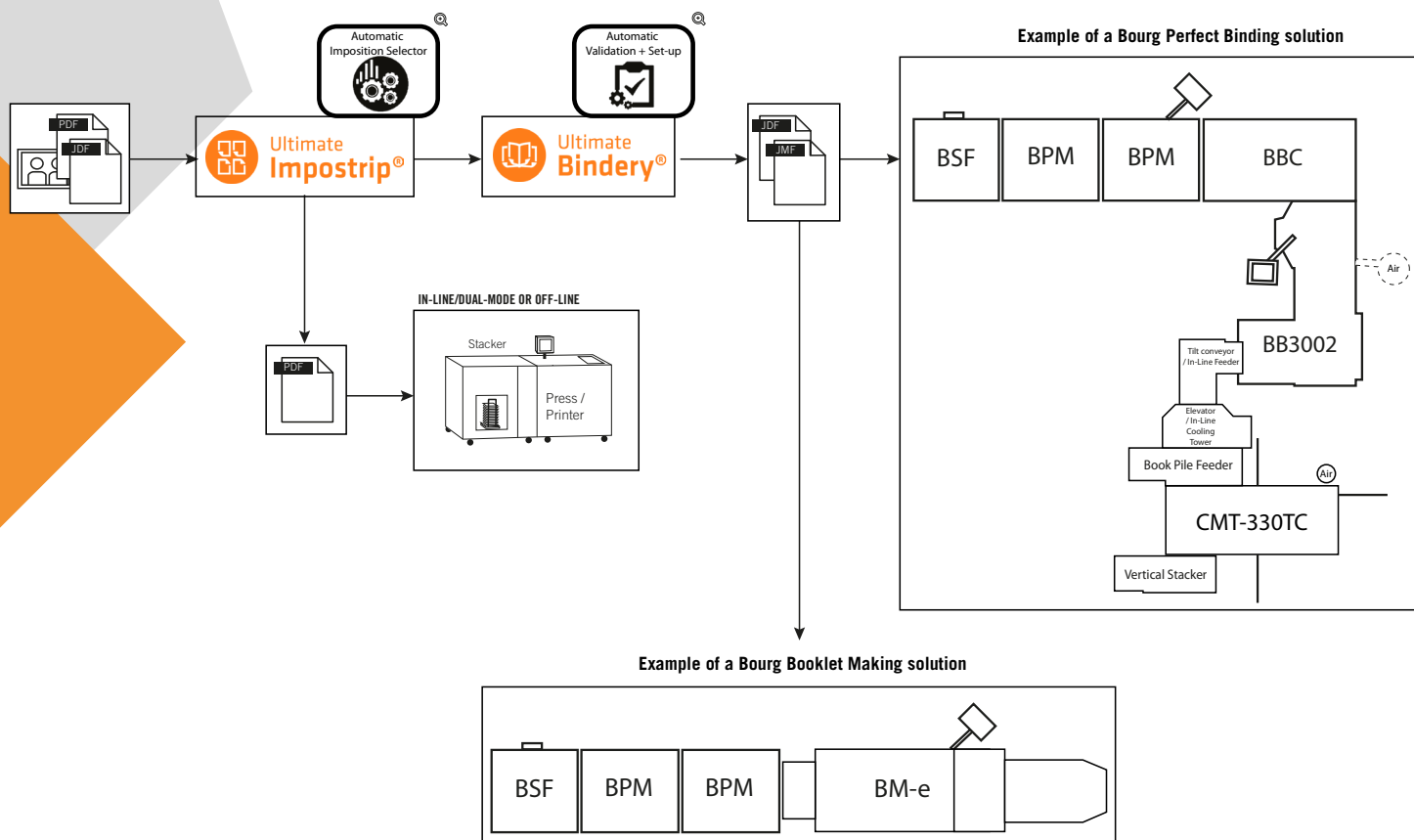

Contact our local distributor to get
your personalised solution
www.cpbourg.com/distributors

TECHNICAL SPECIFICATIONS

Connectability for the barcode imposition software

Compatible with any finishing equipment and can be integrated with any PDF workflow



Maximize throughput and time between the jobs



Minimize potential for human errors and waste



Optimize turnaround time



Provides In-Line communication such as DFA/JDF/XML enabling automated job set-ups

The Bourg Box acts as a protocol converter, through which C.P. Bourg products communicate with virtually any type of digital printer through electronic job tickets.

The job tickets come in two standard formats, JDF and JMF, and are initially generated automatically by a customer's electronic order for print services.

The automated communication synchronises production instructions, prevents production of «impossible jobs» and handles automatic document size changeovers to accommodate, with peak efficiency, any type of job in the production system. The result is a touchless Web-to-Finish workflow.



Let the Bourg Box do the work for you: instructions for incoming jobs are converted in the pre-press software into an electronic JDF job ticket. When the Print Manager submits the job to the printer, it sends the corresponding JDF job ticket to the Bourg Box. The Bourg Box then translates those instructions for the connected Bourg finishing modules.

- Connect Bourg Box In-Line with a printer and/or C.P. Bourg finishing equipment to have fully automated finishing during job production using information supplied from dedicated pre-press software.

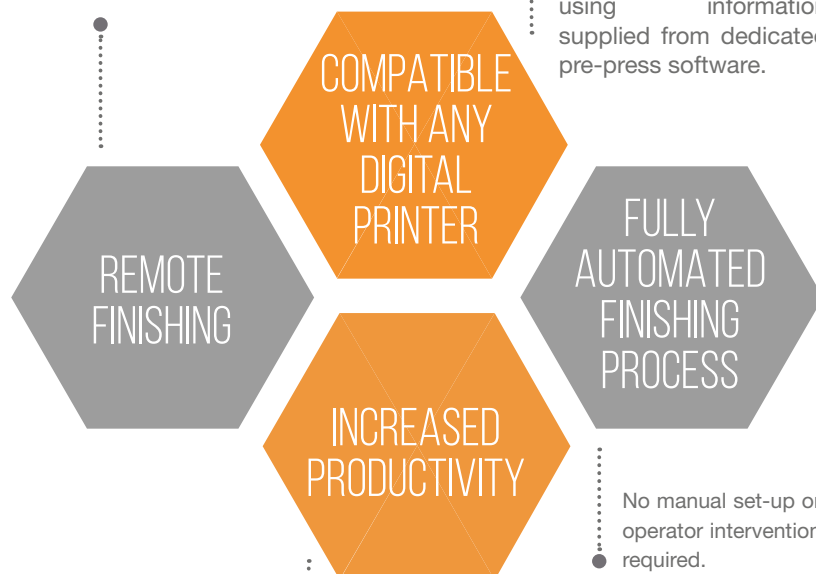

During job set-up all mechanical functions are automatically adjusted to accommodate the specified sheet size, bleed trim, crease dimensions, number of sheets, stitch position, as well as fold and trim dimensions without operator involvement. The Bourg Box also notifies the printer when a job is about to be finished, so that instructions for the next print job are sent on time.



c.p. bourg®
Your Partner in Print Finishing

OFF-LINE

IN-LINE

This is simply the reading direction. Our solutions work In-Line with the right-to-left and left-to-right paper path process of a growing number of production printers/presses.

IN-LINE

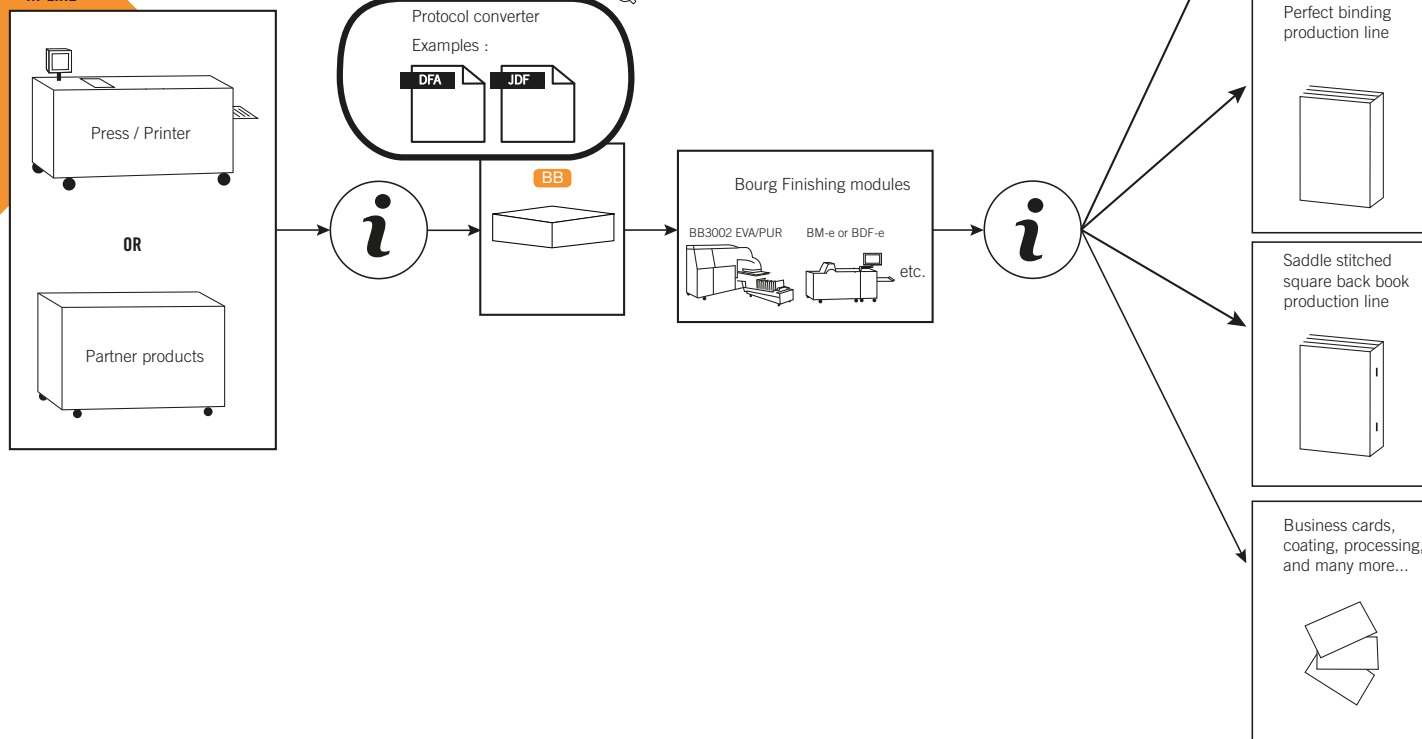

Contact our local distributor to get
your personalised solution
www.cpbourg.com/distributors

TECHNICAL SPECIFICATIONS

Physical

Dimensions (L x W x H)	49,5 x 40 x 16 cm (19.48 x 15.74 x 6.29 in)
Weight	7 kg (15.43 lbs)

Electrical

Power supply	100V, 60Hz, 2A 230V, 50Hz, 2A
--------------	----------------------------------

Connectability

Bourg Sheet Feeder (BSF)
Bourg Booklet Maker (BM-e)
Bourg Document Finisher (BDF-e)
+ Various partner products (for more information, visit the website)

BOURG INTERFACE FEEDER BOOKLET MAKER & PERFECT BINDER

IFB



Minimal time lost & waste to faulted jobs



Enables manual feeding of faulted jobs



Connectable to all our booklet makers, perfect binders and selected finishing partner products

The Bourg Interface Feeder Booklet Maker & Perfect Binder (IFB) serves an error reject station. It is a recommended accessory to connect the Bourg Sheet Feeder (BSF) to any Bourg booklet making and perfect binding modules: the Bourg Document Finisher (BDF-e), the Bourg Bleed Crease Module (BCM-e), the Bourg Booklet Maker (BM-e) and the Bourg Binder BB3202 EVA / hot melt / PUR-Compact.

The IFB can also be connected to several validated downstream finishing partner products.



The IFB automatically ejects jobs in case of a double feed or a wrong barcode sequence. Once the operator corrected the issue with the faulty job, it can be manually fed back through the IFB. As a result, the IFB minimizes the downtime and waste associated with faulted jobs.

The paper-path can follow either a right to left or a left to right process, and work In-Line with multiple digital printers/presses. Find the full list of compatible printers/presses & products on our website: <https://www.cpbourg.com/ifb>

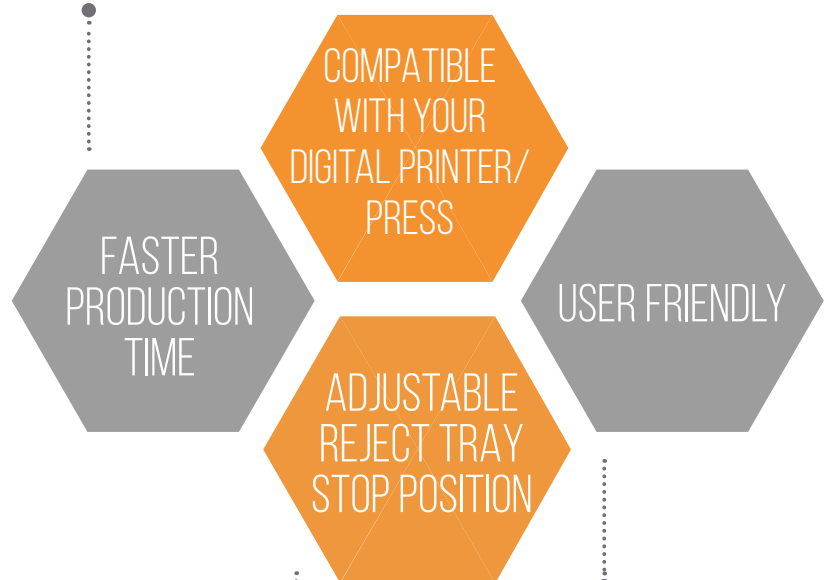

You may adjust or remove the magnetic reject tray stop position depending on paper format.

Easy maintenance and jam removal. Only the good documents go through.

OFF-LINE

IN-LINE



c.p. bourg
Your Partner in Print Finishing

This is simply the reading direction. **Our solutions are bi-directional.** They work In-Line with the right-to-left and left-to-right paper path process of a growing number of production printers/presses.

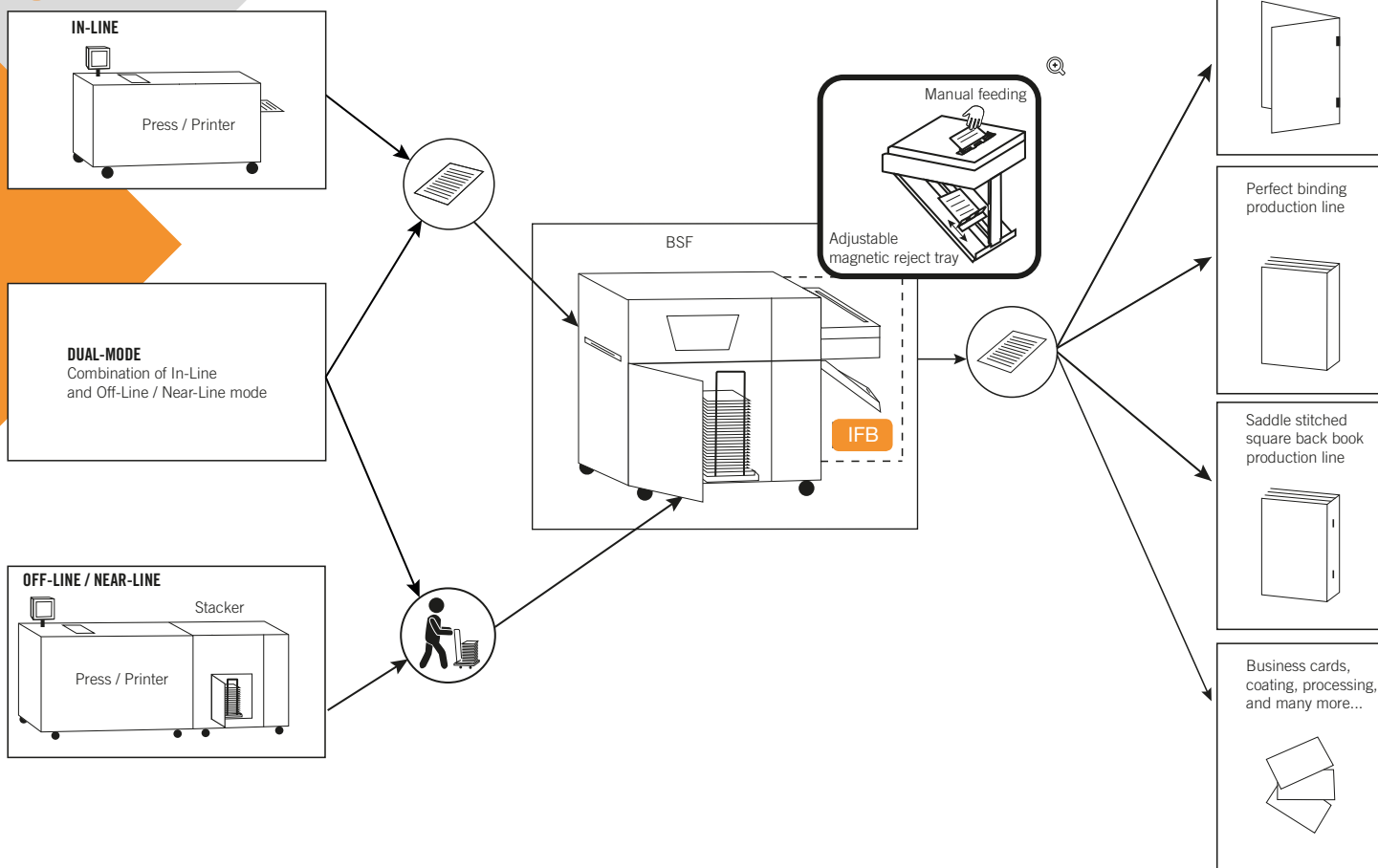

IFB



Contact our local distributor to get
your personalised solution
www.cpbourg.com/distributors

TECHNICAL SPECIFICATIONS

Media

Paper weight	60 to 350 gsm
Min paper size	203,2 x 120 mm (8.00 x 4.72 in)
Max paper size	660,4 x 364 mm (26.00 x 14.33 in)

Physical

Dimensions (L x W x H)	61,5 x 58,2 x 93 cm (24.21 x 22.91 x 36.61 in)
Weight	21 kg (46.29 lbs)



Robotized book repositioning for three-sides cut



Maximum speed in multiple book mode of up to 500 books/hour



Stack up to three books per cutting cycle



Hydraulic clamping and cutting action: cut through books up to 50,8 mm (2.00 in) thick



Precision knife depth control: full control of knife stroke depth, reduces wear to cut sticks and the need for continued knife adjustments



Operational simplicity: smart self-diagnostic assistances and error-indication



Variable mode data entry with up to 99 jobs stored in memory



Sturdy steel and cast-iron long lasting design



No tools are required to perform manual adjustments or exchange book clamps

The CMT-130TC is a hydraulic single-knife book trimmer with robotized book rotation that provides the same functionality as a three-knife trimmer but at lower cost and with consistent product quality.

This fully automated three-side book trimmer finishing solution is designed for on-demand and short-run digitally printed perfect-bound books. It is capable of fulfilling a combination of both Off-Line and In-Line feeding systems with the Bourg Binder BB3x02 family.



With the proper configuration of feeding components, the CMT-130TC is capable of automatically switching, as needed, between feeding books directly from an attached Bourg Binder BB3x02 OR from a manually loaded Off-Line book pile feeder system. If one system is waiting for its next book, the other system can feed the trimmer to maximize production throughput.

Automatic size detection of pre-trimmed books means only three dimensions are required for job programming.

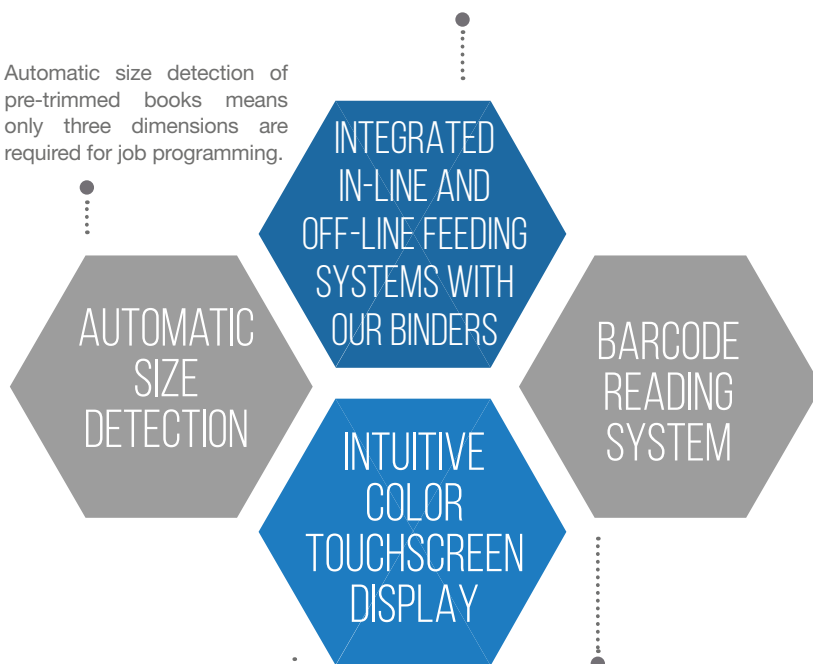

Intuitive 10.5" (26,7 cm) color touchscreen display provides a clear & easy-to-read image of the trimming system. Automatic starting book size detection simplifies the required job parameters making job entry quick and easy. Follow each book as it travels through the system on live graphical display,

Integrated barcode reading system's 1D/2D enables true fully-automated book-of-one production by automating job set-up.



c.p. bourg
Your Partner in Print Finishing

OFF-LINE

IN-LINE

DUAL-MODE
WITH BOOK
PILE FEEDER

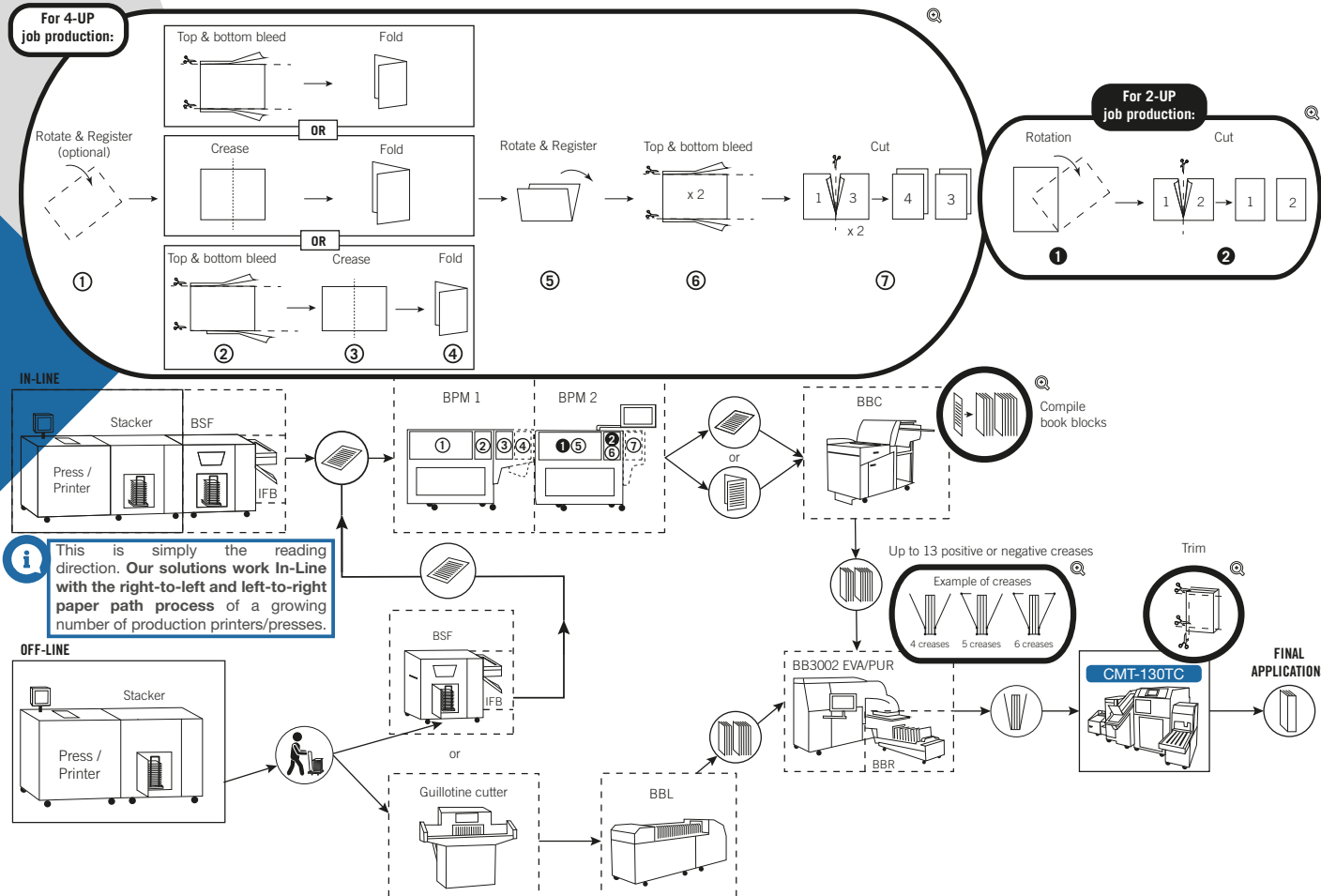

Contact our local distributor to get
your personalised solution
www.cpbourg.com/distributors

TECHNICAL SPECIFICATIONS

Media

Maximum speed single book mode	200 books/hour
Maximum speed multiple book mode	500 books/hour

TRIM

Minimum (all sides)	2,5 mm (0.1 in)
Maximum Top	152 mm (5.98 in)
Maximum Bottom	89 mm (3.50 in)
Maximum Face	140 mm (5.51 in)

Physical

Dimensions (L x W x H)	144,8 x 132,1 x 152,4 cm (57 x 52 x 60 in)
Weight	680 kg (1,500 lbs)
Floor loading	3,73 kg/cm³ (53 PSI)
Waste bin capacity	164 liters (43 gallons)
Oil capacity	19 liters (5 gallons)
Knife re-grind	6,4 mm (0.25 in)

Electrical

Power supply (standard motor)	208/230V ±10%, 60Hz, 3 phase, 20A
Power supply (optional motor)	380/415V ±10%, 50Hz, 3 phase, 12A

Options/Accessories

Barcode reader & imposition solutions

Connectability

Bourg Binder BB3x02 EVA / Hot melt / PUR-C family	Exit conveyor
Near-Line Book Pile Feeder	In-Line conveyor
In-Line Cooling Tower	Output Vertical Stacker

Air supply

Requires compressed air (compressor not included) & constant air quality: see the website for more information

MEDIA SIZES

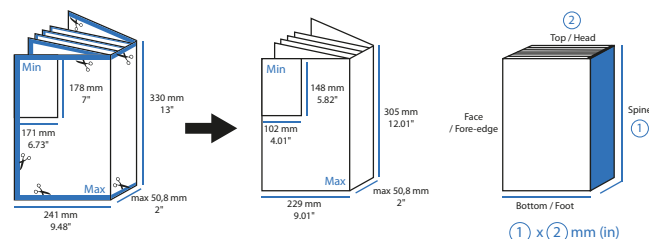

THREE-KNIFE TRIMMER CMT330-TC

TRIMMER

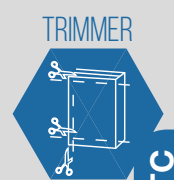

CMT-330TC



Three-knife trimming process



Stacks up to three books per cutting cycle



Powerful hydraulic cutting and clamping pressure to effortlessly cut books from 2,5 mm (0.1 in) up to 50,8 mm (2.00 in)



Operational simplicity: smart self-diagnostic assistances and error-indication



Fast and accurate book size changes set-ups in under six seconds (no tools required)



Precision knife depth control: full control of knife stroke depth, reduces wear to cut sticks and the need for continued knife adjustments



Better waste management



Variable mode data entry with up to 99 jobs stored in memory

The new generation of CMT-330TC three-knife trimmer introduces all the flexibility necessary to the book trimming operation in today's publishing marketplace. It is now capable of fulfilling a combination of both Off-Line and In-Line feeding systems with the Bourg Binder BB3x02 family to provide the final touch on your perfect bound books.

The CMT-330TC has also expanded its capabilities: trim landscape formatted books such as photo books (up to 307 x 328 mm – 12.1 x 12.9 in) is one example out of many.

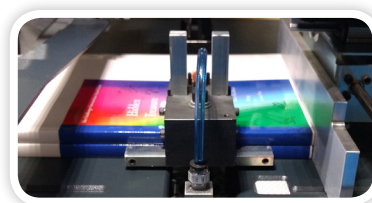

With the proper configuration of feeding components, the CMT-330TC is capable of automatically switching, as needed, between feeding books directly from an attached Bourg Binder BB3x02 OR from a manually loaded Off-Line book pile feeder system. If one system is waiting for its next book, the other system can feed the trimmer to maximize production throughput.

Automatic size detection of pre-trimmed books means only three dimensions are required for job programming.

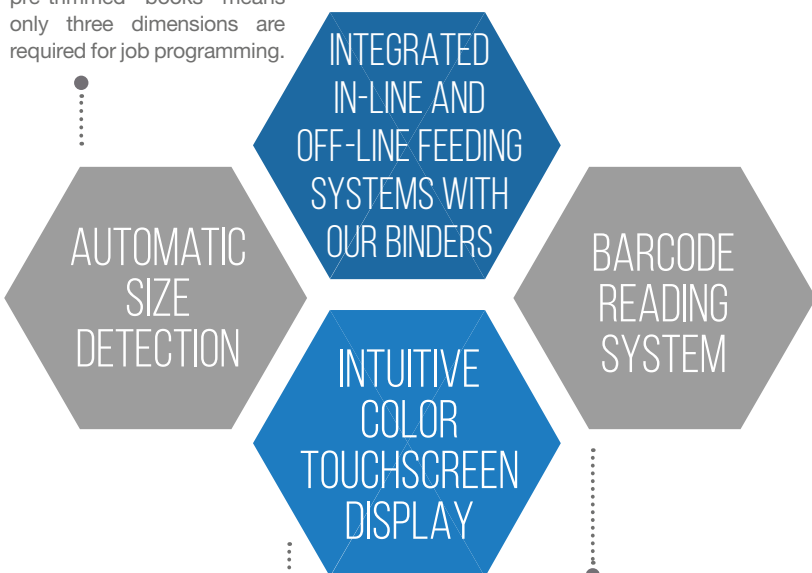

Intuitive 10.5" (26,7 cm) color touchscreen display provides a clear & easy-to-read image of the trimming system. Automatic starting book size detection simplifies the required job parameters making job entry quick and easy. Follow each book as it travels through the system on live graphical display,

Integrated barcode reading system's 1D/2D enables true fully-automated book-of-one production by automating job set-up.



c.p. bourg®
Your Partner in Print Finishing

OFF-LINE

IN-LINE

DUAL-MODE
WITH BOOK
PILE FEEDER

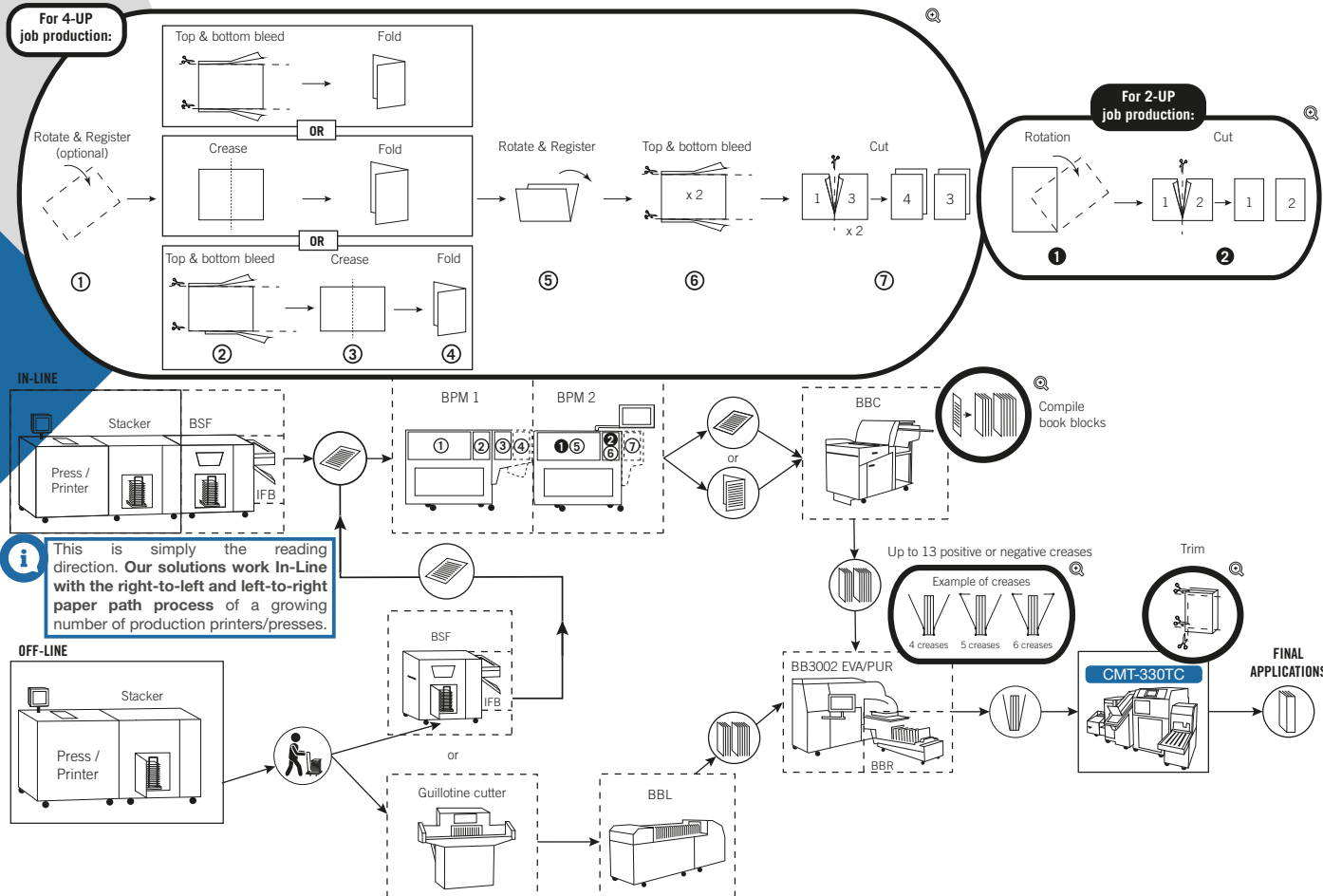

Contact our local distributor to get
your personalised solution
www.cpbourg.com/distributors

TECHNICAL SPECIFICATIONS

Media

Maximum speed single book mode 400 books/hour

Maximum speed multiple book mode 750 books/hour

TRIM

Minimum (all sides) 2,5 mm (0.10 in)

Maximum Top 152 mm (6.00 in)

Maximum Bottom 89 mm (3.50 in)

Maximum Face 203 mm (8.00 in)

Physical

Dimensions (L x W x H) 229 x 97 x 157 cm
(90 x 38 x 62 in)

Weight 1,300 kg (2,900 lbs)

Floor loading 483 kg/cm² (70 PSI)

Waste bin capacity 164 liters (43 gallons)

Oil capacity 19 liters (5 gallons)

Knife re-grind 6,4 mm (0.25 in)

Electrical

Power supply (motor 60 Hz) 208/230V ±10%, 60Hz, 3 phase, 25A

Power supply (motor 50 Hz) 380/415V ±10%, 50Hz, 3 phase, 16.5A

202/208V ±10%, 50Hz, 3 phase, 25A

Options/Accessories

Barcode reader & imposition solutions

Connectability

Bourg Binder BB3x02 EVA / Hot melt / PUR-C family

Book Pile Feeder IL NL for CMT-330TC

Book Pile Feeder NL for CMT-330TC

Exit conveyor for CMT-330TC

In-Line conveyor for CMT-330TC

In-Line Cooling Tower for CMT-330TC

Output Vertical Stacker for CMT-330TC

Air supply

Requires compressed air (compressor not included) & constant air quality: see the website for more information

MEDIA SIZES

